

Insulation

To keep your home warm, proper insulation is required hence floor, wall, ceiling and partition wall insulation should be applied. There are some important rules to follow during insulation - see the bottom of estimation.

Estimation conditions

- materials are delivered on site
- internal transport horizontal and vertical is included in the average building situation
- calculation of materials includes an allowance for waste
- water, electricity, and small amount of materials are added with 1.5% rate calculated from basic materials

Sequence of operation

- insulate floor surface with proper insulation products eg PIR insulation
- insulate stud partition wall
- insulate ceiling construction
- insulate cavity wall

Coverage of materials for making 1sqm of insulation

No	Material	Unit	Price* excl VAT [pcs]	Coverage	Photo	Price excl. VAT	Price incl. VAT
1	Floor insulation PIR board 100mm thick 1200*2400mm = 2.88sqm	sheet	£45.75	0.365sh/sqm		£16.70/sqm	£20.04/sqm
2	Partition wall mineral wool KNAUF Earthwool 75mm 0.455m*1.2m @ 8 slabs = 4.37sqm	pack	£15.99	0.25pack/sqm		£4.00/sqm	£4.80/sqm
3	Ceiling accoustic glass wool insulation KNAUF 100mm 2 @ 0.6m*9.17m = 11.00sqm	roll	£37.20	0.095roll/sqm		£3.53/sqm	£4.24/sqm
4	Cavity wall mineral wool insulation ProRox 50mm 0.6m*1.2m @ 9 slabs = 6.48sqm	pack	£25.40	0.17pack/sqm		£4.32/sqm	£5.18/sqm

* products available at above prices in all IBB Builders Merchants branches – retail prices before discounts



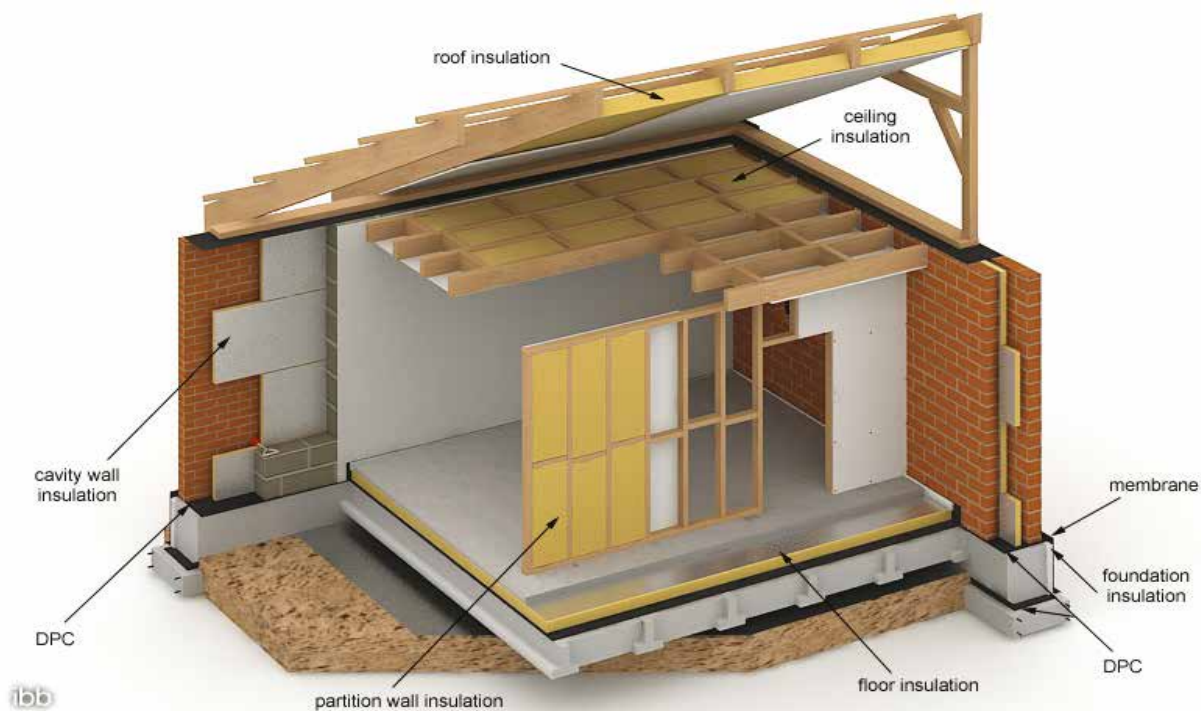

Expenditure of Labour for making 1sqm of insulation

No	Description	Labour hours	Rate excl. VAT [GBP]	Cost [GBP] excl. VAT*	Cost [GBP] incl. VAT
1	Floor PIR insulation	0.082 lh/sqm	£35	£2.87/sqm	£3.44/sqm
2	Partition wall mineral wool insulation 75mm thick	0.12 lh/sqm	£35	£4.20/sqm	£5.04/sqm
3	Ceiling accoustic glass wool insulation 100mm thick	0.15 lh/sqm	£35	£5.25/sqm	£6.30/sqm
4	Cavity wall mineral wool insulation ProRox 50mm thick	0.156 lh/sqm	£35	£5.46/sqm	£6.55/sqm

Important:

- for the proper insulation of cavity wall it's essential to leave gap between both leaves of cavity wall to prevent migration of humidity both to inner leaf and into insulation
- glass wool or mineral wool do not absorb water but structure of insulation made of them does – insulation loses its quality
- proper insulation is required also for avoiding cold bridges
- areas not properly insulated may cause moulds and fungus to arise
- to prevent migration of humidity into insulation it's recommended to use DPM barrier

Usefull tools:



Seek Thermal is the most advanced thermal imaging camera for smartphones

Attention!

Our norms and rates should be taken as a guide only and there are no obligations for anybody to follow them. You have to take sole responsibility and apply your own rates to your quotations. Cost of materials may vary from prices shown. We cannot accept any responsibility for anyone using this information – you must make your own checks.