

Building with Ytong Blocks

Single Leaf Wall

Estimation conditions

- estimated cost for 50m² single leaf wall (thickness 215mm)

NOTICE!

- The below estimation is only the proposal, you can use it at your own risk
- All products are available at IBB; prices before discounts*

Main works and tasks

No	Name	Netto value	Gross value
1	EXTERNAL WALLS	£2,840.80	£3,408.96
1.1	Brick/Block walls	£2,840.80	£3,408.96
1.1.1	Solid brick or block wall	£2,651.08	£3,181.30
1.1.1.1	Lightweight aircrete block walls	£2,651.08	£3,181.30
1.1.1.1.1	Ytong	£2,651.08	£3,181.30
1.1.2	Allowance for window openings	£137.16	£164.59
1.1.3	Fitting lintels	£119.21	£143.05
1.1.3.1	Precast concret lintels	£119.21	£143.05
1.1.4	Fixing other wall accessories	£36.32	£43.58
1.1.4.1	Fixing wall starters	£36.32	£43.58



Material

No	Name	Feature	Dimension	Weight [kg]	Qty	[unit]	Total
1.	lightweigh aircrete block	Ytong, Hi-strength, 7.3N/mm2	600*215*100mm	7850.000	500.000	pcs	£1,665.00
2.	masonry mortar	Silmur M 15	bag=25kg	400.000	16.000	bag	£200.00
3.	wall starter	Ancon 36/8	2@1200mm	4.000	2.000	pcs	£14.48
	Total			8254.000			£1,879.48
Total net:							£1,775.58
VAT:							£375.89
Total gross:							£2,255.38

Labour

No	Name	Rate	Qty	[unit]	Costs	Total
1.	Bricklayer	£12.00	38.808	lh	£465.70	£847.57
2.	Bricklayer mate	£6.00	19.932	lh	£119.59	£217.66
	Total		58.740	lh	£585.29	£1,065.22
Total net:						£1,065.22
VAT:						£213.04
Total gross:						£1,278.27

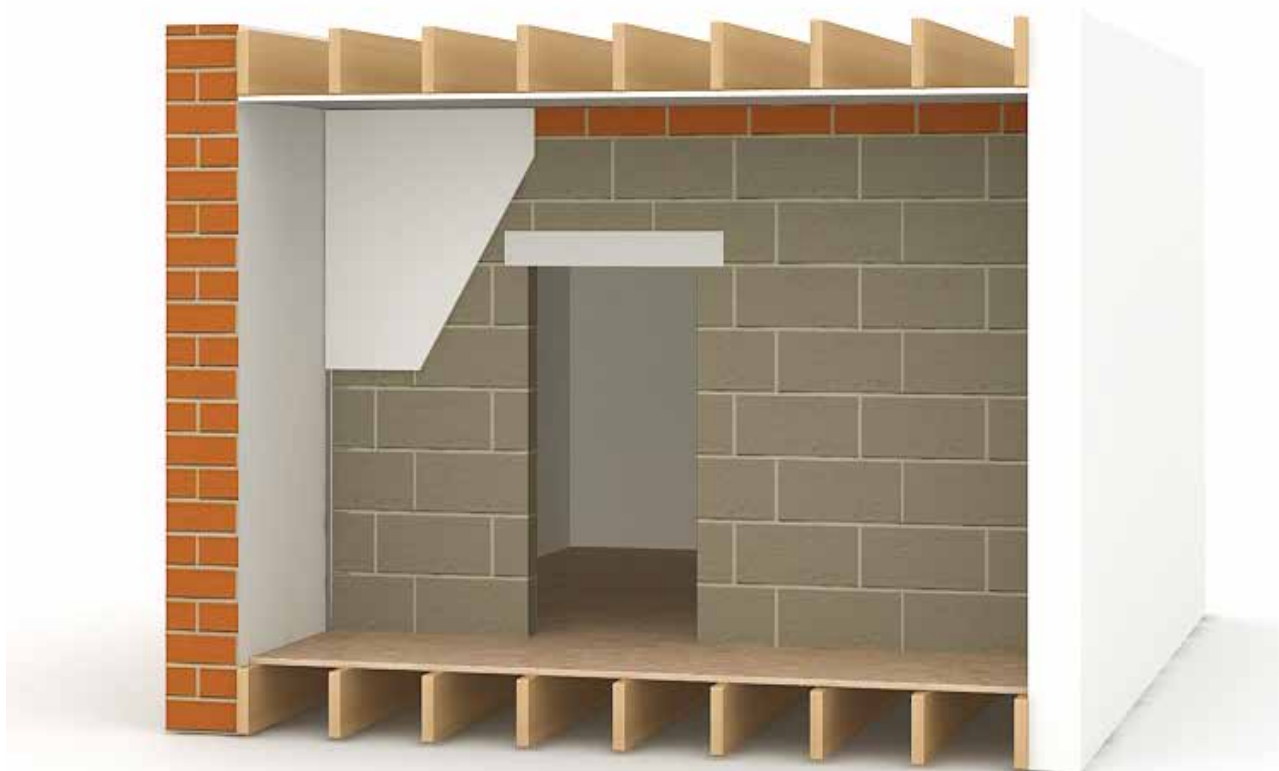

Disclaimer!

Our norms and rates should be taken as a guide only and there are no obligations for anybody to adhere to them. You have to take sole responsibility and apply your own rates to your quotations. Cost of materials can vary from prices shown. We cannot accept any responsibility for anyone using this information – you must make your own checks.

Light Block Foundation

Estimation conditions

- estimated cost for 40m² foundations

NOTICE!

- The below estimation is only the proposal, you can use it at your own risk
- All products are available at IBB; prices before discounts*

Main works

No	Name	Netto value	Gross value
1.	FOUNDATIONS, CONCRETE CONSTRUCTION	£5,074.03	£6,088.84
	Total:	£5,074.03	£6,088.84

Material

No	Name	Feature	Dimension	Weight [kg]	Qty	[unit]	Total
1.	lightweigh aircrete block	Ytong, foundation, 4.0N/mm ²	440*215*300mm	7240.000	400.000	pcs	£2,640.00
2.	masonry mortar	KT 28 masonry mortar	bag.=25kg	7200.000	288.000	bag	£1,346.40
	Total			14440.000			£3,986.40
Total net:							£3,986.40
VAT:							£797.28
Total gross:							£4,783.68

Labour

No	Name	Rate	Qty	[unit]	Total
1.	Bricklayer	£12.00	36.000	lh	£786.24
2.	Bricklayer mate	£6.00	27.600	lh	£301.39
	Total		63.600	lh	£1,087.63
Total net:					£1,087.63
VAT:					£217.53
Total gross:					£1,305.16

Attention!

Our norms and rates should be taken as a guide only and there are no obligations for anybody to adhere to them. You have to take sole responsibility and apply your own rates to your quotations. Cost of materials can vary from prices shown. We cannot accept any responsibility for anyone using this information
- you must make your own checks.

