

# External Wall Insulation & Render System

IBBTherm are the best, carefully selected by us, most cost effective external render materials on the market ! We describe below the most popular version of elevation done with acrylic render, white, dotted finish with grain thickness of 1.5 mm.

## Estimation conditions:

- materials are delivered on site
- internal transport horizontal and vertical is included in the average building situation
- labour included fitting light scaffolding up to 4m high
- calculation of materials includes an allowance for waste
- water, electricity, and small amount of materials are added with 1.5% rate calculated from basic materials

## Sequence of operation:

- clean and prime the surface
- fix base metal track according to thickness of polystyrene sheets

- prepare adhesive – mix powder with water
- cut and glue polystyrene panels to the wall
- drill holes and fix polystyrene panels with plastic plugs
- prepare polystyrene joints with the special trowel to make an even surface
- fix PVC corners with mesh to the external corners and revals
- apply adhesive basecoat reinforced with fibreglass mesh on top of polystyrene panels
- prime basecoat with primer
- mix acrylic render in bucket
- apply render with the steel trowel
- work wet render with plastic trowel to receive decorative finish
- protect with dust sheet and foil or plastic against rain and sun

## Coverage of materials for making 1sqm topcoat acrylic render with insulation; system insulated with graphite polystyrene panels 5cm thick

No	Material	Unit	Price* excl VAT [pcs]	Norm for 1m <sup>2</sup> wall	Unit price excl. VAT [GBP]	Price excl. VAT for 1m <sup>2</sup> wall	Price incl. VAT for 1m <sup>2</sup> wall
1	IBBTherm AP 10 – acrylic primer	can 5l	£ 6.75	0.07l/m <sup>2</sup>	£ 1.35/l	£ 0.09	£ 0.11
2	Metal track 53/2500mm	pcs	£ 2.75	TBC eg. 0.20m/m <sup>2</sup>	£ 1.10/m	£ 0.22	£ 0.26
3	Foamed polystyrene EPS 70-032 FACADE, graphite 5cm thick	1m <sup>2</sup>	£ 2.48	1.05m <sup>2</sup>	£ 2.48/m <sup>2</sup>	£ 2.60	£ 3.12
4	Fixings for polystyrene panels 11-10x90mm plugs	pcs	£ 0.10	6 szt/m <sup>2</sup>	£ 0.10/szt	£ 0.60	£ 0.72
5	PVC corner with mesh 2.50m	pcs	£ 1.40	TBC eg. 0.50m/m <sup>2</sup>	£ 0.56/m	£ 0.28	£ 0.34
6	IBBTherm PMA 11 – adhesive for glueing polystyrene panels and basecoat reinforced with fibreglass mesh	bag 25 kg	£ 6.25	8.0kg/m <sup>2</sup>	£ 0.25/kg	£ 2.00	£ 2.40
7	Fibreglass mesh 145g/m <sup>2</sup>	roll 50 m <sup>2</sup>	£ 19.50	1.135m <sup>2</sup> /m <sup>2</sup>	£ 0.39/m <sup>2</sup>	£ 0.44	£ 0.53
8	IBBTherm AU 10 – contact primer	bucket 25kg	£ 34.50	0.25kg/m <sup>2</sup>	£ 1.38/kg	£ 0.35	£ 0.42
9	IBBTherm AT 100 – acrylic top coat render dotted 1.5mm	bucket 25kg	£ 21.25	ca 3.0kg/m <sup>2</sup>	£ 0.85/kg	£ 2.55	£ 3.06
10	Additional materials 1.5%					£ 0.14	£ 0.16
<b>Total</b>						<b>£9.27</b>	<b>£11.12*</b>

\* products IBBTherm available at above prices in all IBB Polish Building Wholesale branches – after the greatest 40% discounts for IBBestimator PRO users and during promotion

**Expenditure of labour for making 1sqm elevation like above**

No	Description	Labour hours	Rate excl.VAT [GBP]	Rate [GBP] per 1sqm excl.VAT	Rate [GBP] per 1sqm incl.VAT
1	Priming substrate and base coat surface before applying top coat render	0.066 labour/m <sup>2</sup> *	£ 14,-	£ 0.92	£ 1.10
2	Fixing metal track	0.237 l/m	£ 14,-	-	-
3	Glueing polystyrene panels	1.329 l/m <sup>2</sup> *	£ 14,-	£ 18.61	£ 22.33
4	Fixing corners with mesh	0.220 l/m	£ 14,-	-	-
5	Coating mesh with adhesive	0.611 l/m <sup>2</sup> *	£ 14,-	£ 8.55	£ 10.26
6	Applying top coat render	0.493 l/m <sup>2</sup> *	£ 14,-	£ 6.90	£ 8.28
<b>Total</b>		<b>2.606 l/m<sup>2</sup>*</b>		<b>£ 34.98</b>	<b>£ 41.97</b>

**Attention:** Attention: in our quotation we have only described positions marked \*, the rest you have to calculate individually eg. fixing corners with mesh according to how many reveals there are on the elevation, it is also important that for reveals you have to increase the quotation, the same for scaffolding or colour render.

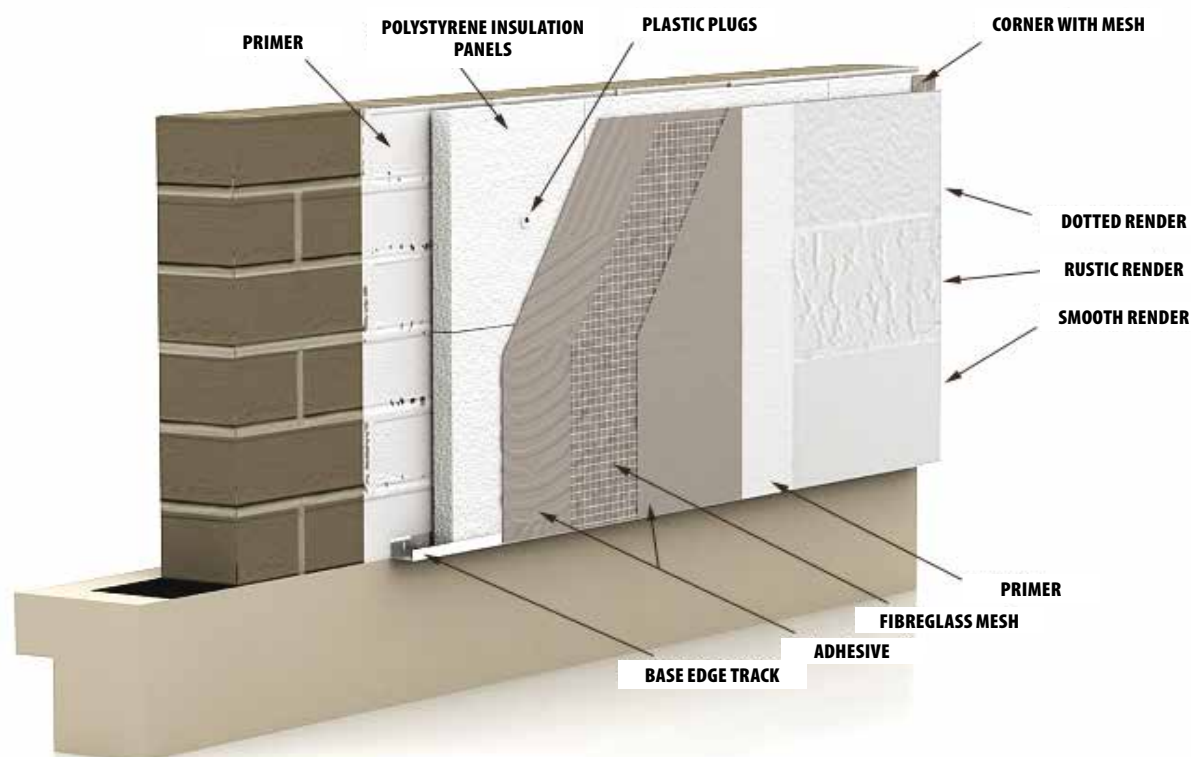

Adhesive

Polystyrene panel

Mesh

Primer

Render

Plug

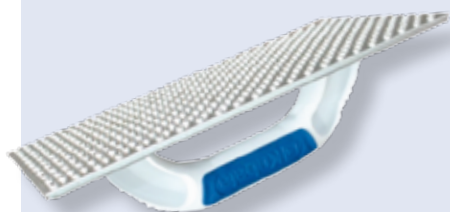

Cost of Materials for the most popular External Wall Insulation System with polystyrene EPS-70-032 graphite insulation 50mm thick, acrylic render - dotted, white colour, 1.5mm grain after the greatest discount level is **£ 9.27 net/sqm**

**Useful tools**

*Trowel  
with sandplate*

**£4.58\***



*Plastic trowel  
for decorative render*

**£3.40\***



*Scraper  
for old renders*

**£13.75\***

*\* Prices incl. VAT before discount*

**Attention!**

Our norms and rates should be taken as a guide only and there are no obligations for anybody to adhere to them.; you have to take sole responsibility and apply your own rates to your quotations. Cost of materials can vary from prices shown on the manufacturers specification We cannot accept any responsibility for anyone using this information – you must make your own checks.

# Important information regarding building elevation:

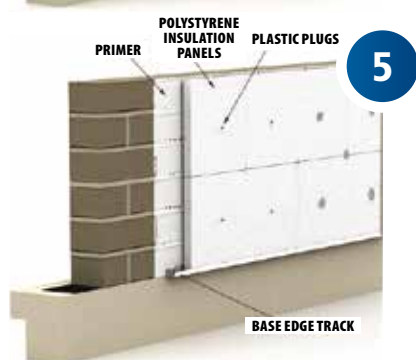
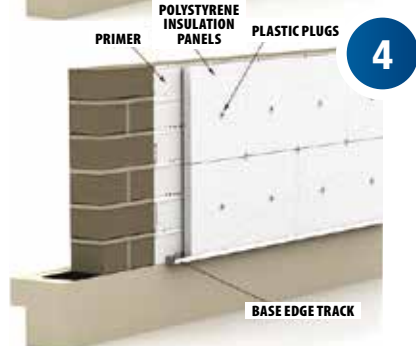
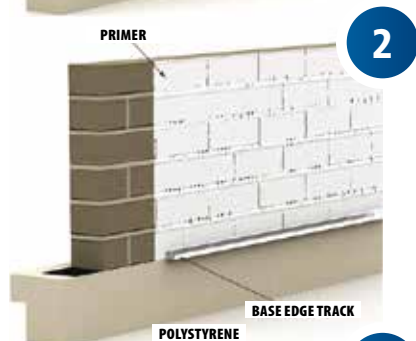
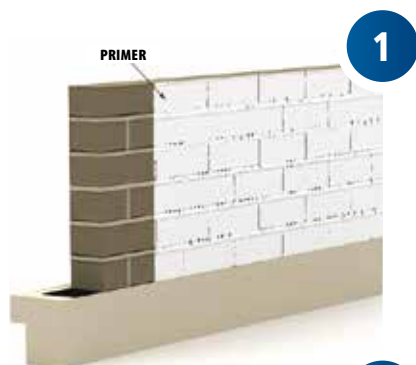

- while choosing metal edge strip, please mind that both thickness of polystyrene panels and thickness of adhesive are important
- apply adhesive around the edge of polystyrene panel and in the middle
- fix plugs only in the area where the adhesive is applied
- attention: it is not necessary to fix polystyrene panels with plugs when the elevation is a small area. Adhesive only will do the job
- in the UK you should cover the fixing screws with polystyrene plugs to protect against the cold bridge
- when preparing insulation surface, an adhesive layer, etc. should be done carefully and evenly; the adhesive surface should not be sanded – otherwise it is difficult to apply the render and get a good finish
- the thickness of one coat is only the thickness of the grain used in the render – you can not level the surface by just applying another layer of render
- the surface area of one level elevation should be done continuously from one side to the another without a break, by two people – one for applying the render and second one for making the decorative finish. If you allow part of a surface to dry before continuing it will leave ripples on the surface
- do not apply render during rain or bright sunshine
- if some render drops from the elevation during application – do not re-use it
- you can check the skills and experience of your builders by looking under the scaffolding for fallen render
- you can use a pre-coloured render but remember - if you use an acrylic external paint always wait 28 days
- you can paint after 24 hours but you must use a silicat external paint
- if you use a coloured render make sure it is an acrylic one
- for insulating polystyrene panels you can use 2-3 cm thickness but there is no matching edge metal strip to be found
- you can apply thin layer render on to old cement based render – but cleaning, priming and applying fiberglass mesh with adhesive is a must
- in some situations it is necessary to fit insulated rendering system with special buttons
- new render finishes should be protected against weather, especially rain, by using plastic sheeting – repairing damaged render can only be done by applying a new layer of adhesive with mesh and new decorative render

