

# Tanking system with Kontract Mesh membrane

## - waterproof barrier bonded to the walls holding water out of structure

### Requirements:

- The tank should include all walls and floor in a continuous system
- Any holes in the tank should be sealed
- Mesh membranes are fixed to the wall using Plaster Plugs & seals max 250mm from each other
- Tough HDPE mesh surface allowing for direct application of various plaster finishes or adhesive dabs for plasterboard
- It may be necessary to install channels and pumping mechanisms to collect and remove water
- Aqua channel can be serviced by inserting jetting eye into the system
- If there are any services up through the floor should be sealed as well
- 30 years Wykamol products guarantee

Quotation for 20sqm basement conversion with tanking system (without finishing)

### Additional conditions:

- All organic materials must be removed to prevent risk of fungal growth
- Existing moulds should be removed
- Any sharp edges, oil or loose materials both on the floor and wall should be removed
- Drainage system should be tested before covering with the floor membrane
- Another test is recommended after laying floor membrane
- Each sheet of membrane is sealed with tape together with overlapping by minimum three rows of studs
- Floor membrane and wall membrane are sealed with 150mm width Corner Tape

### Dimensions:

- Floor area 20sqm
- Wall surface 40sqm
- Drainage length 18m

### MATERIALS

Materials – tanking system typical 20sqm basement

No	Material	Code/dim	Picture	Usage	Price* excl.VAT unit	Usage for 20m2 basement	Cost* excl. VAT	Cost* incl. VAT
1	Wall membrane with mesh	Kontract mesh 2*10m		1.20 sqm/sqm	£183.33	2.4 roll	£439.99	£527.99
2	Sealing Overtape	75mm*22.5m		0.05 m/m	£53.92	1.0 roll	£53.92	£64.70
3	Standard tape	28mm*22.5m			£29.67	1.0 roll	£29.67	£35.60
4	Plugs to wall membrane	Plaster plugs 8*70mm		18.00 pcs/sqm	£ 0.29	720.0 pcs	£208.80	£250.56
5	Floor membrane	Kontract 20 2.07*20m		1.20 sqm/sqm	£332.92/roll	1.2 roll	£399.50	£479.40
6	Corner tape	150mm*20m			£74.83	1.0 roll	£74.83	£89.80
6	Aqua chennels	2.2m			£28.17	9.0 pcs	£253.53	£304.24
7	Universal channel outlet			1.00 pcs	£54.50	1.0 pcs	£54.50	£65.40
8	Drain end			1.00 pcs	£34.63	1.0 pcs	£34.63	£41.56
9	Jetting eye			1.00 pcs	£32.32	1.0 pcs	£32.32	£38.78
10	Sumpflo kit, single pump	Sumpflo kit		1.00 set	£1,158.33	1.0 set	£1,158.33	£1,390.00
11	Sump monitoring unit			1.00 set	£381.67	1.0 set	£381.67	£458.00
<b>Total</b>							<b>£3,121.69.49</b>	<b>£3,746.03</b>

\* all products available at IBB; prices before discounts

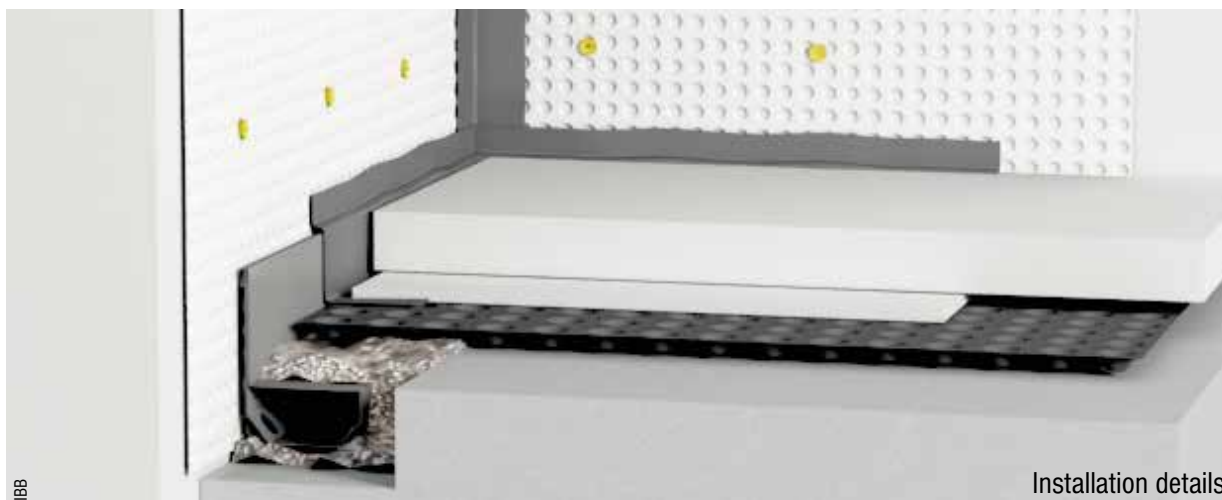

## MATERIALS

Labour – tanking system typical 20sqm basement

No	Description	Labour per unit	Q-ty	Labour [lh]
1	Creating channel in concrete slab for drainage	0.34 lh/m	18.0 m	6.12
2	Digging whole for sump chamber	4.90 lh/m <sup>3</sup>	0.6 m <sup>3</sup>	2.94
3	Installing aquachannels	0.08 lh/m	18.0 m	1.44
4	Installing sump pump	6.00 lh/set	1.0 set	6.00
5	Installing sump alarm	1.20 lh/set	1.0 set	1.20
6	Fitting Kontract mesh to the wall with plaster plugs	0.60 lh/sqm	40.0 sqm	24.00
7	Fitting additional sealing tape for joints	0.08 lh/m	22.0 m	1.76
8	Plugs to wall membrane	0.06 lh/pcs	720.0 pcs	43.20
9	Fitting floor membrane	0.12 lh/sqm	20.00 sqm	2.40
<b>TOTAL</b>				<b>89.06</b>

No	Description	Labour [labour hours]	Company rate* excl.VAT	Cost excl. VAT	Cost incl. VAT
1	Labour	89.06	£27.00	£2,404.62	£2,885.54

\* gross company rate varies depending on net company rate, overheads, profit margin

## APPLICATION TOOLS AND ANCILLARY COMPONENTS

Tools and ancillary components

No	Material	Code/dimensions	Price* excl. VAT	Price incl. VAT
1	Cutting knife	18mm	£1.83	£2.20
2	Spare blades	18mm	£1.25	£1.50
3	Mallet	Maxter	£4.08	£4.90
4	Cutting shears		£7.08	£8.50
5	Tape measure	8 m	£9.17	£11.00
6	Spirit level	PN 47 2.5m	£47.49	£57.50
7	Drill bits 8mm	8*160mm	£2.25	£2.70
8	Trestle staging	Compact A	£337.67	£405.20
9	Lighting – halogen lamp on tripod	500 W	£22.42	£26.90

\* all products available in IBB; prices before discounts

### Notice!

Above estimation is only an example and you can use it on your own risk. Use PPE – Personal Protection Equipment and establish Health&Safety practice